

INSTALLATION INSTRUCTIONS FOR WALL MOUNTED LIGHT FIXTURES

WARNING! SHUT OFF POWER AT FUSE OR CIRCUIT BREAKER BEFORE DOING ANY ELECTRICAL WORK.

PREPPING THE AREA

- 1) Shut off power at the fuse box or circuit breaker. Make sure that people in the vicinity know not to restore power without first consulting the person who shut off the power.
- 2) If there is an existing wall fixture, remove it completely, including the mounting hardware.
- 3) Open the packaging and ensure that all parts have been included, including the hardware needed to attach to the junction box in the wall. Please note that the hardware for one product may not match exactly the hardware of a different fixture.
- 4) Most wall fixtures will come with a circular mounting plate that should be mounted to the junction box, using the included hardware. See image to the right. The side marked "GND" must face out.

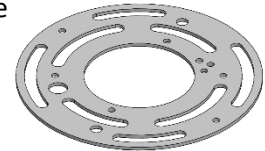

CONNECTING THE WIRING

- 1) Use another person to hold the light fixture close to the wall while making the wiring connections. Using the included wire nuts, connect the black wire from the light fixture, to the black wire from the junction box. When the connection has been made, and the wire nut twisted onto the end of each wire, give one of the wires a pull. If the wire comes loose, twist the wire nut off the wires, and try again. Once both wires are securely connected, the wire connections should be tucked neatly inside the junction box.
- 2) Repeat the above step for the white wire, connecting the light fixture to the junction box.
- 3) If the junction box has a ground wire, connect it to the light fixture's ground wire, using the same method as the black and white wire. If the junction box does not have a ground wire, simply connect the ground wire from the light fixture to the circular mounting plate and secure it in place with the green grounding screw.

FINISHING INSTALLATION

- 1) Once the light fixture has been completely assembled, all bulbs have been placed in each socket if necessary, the installation is complete. Restore power, and test the fixture. If the fixture does not turn on, the wiring connections will need to be checked to make sure that nothing came loose.